

E-Schweissbare Fittings

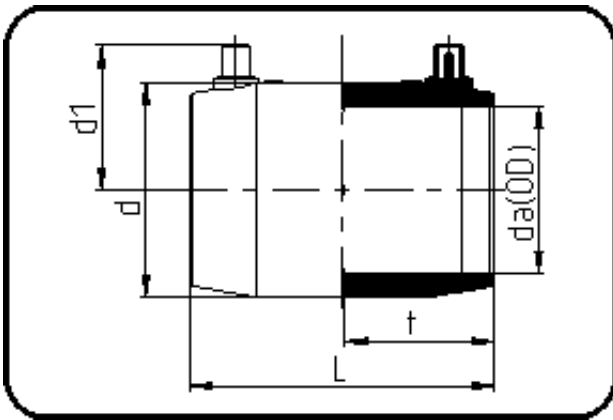

Code: 173

- E-Muffe
- MOP Wasser 10bar / Gas 6bar
- W/P-TW
- formgespritzt
- **Heizwendelschweissung**
- **PE 100-RC schwarz**

Dimension	Code	Detail	Gewicht
90	70.173.0090.17	90 SDR 26-17	0.36

	Einheit	Nominale	Tol+	Tol-
da(OD)	mm	90	0.00	0.00
L	mm	138,5	4.50	0.00
d	mm	109	1.50	1.50
d1	mm	74	1.50	1.50
t	mm	67,5	4.50	0.00