

E-Schweissbare Fittings

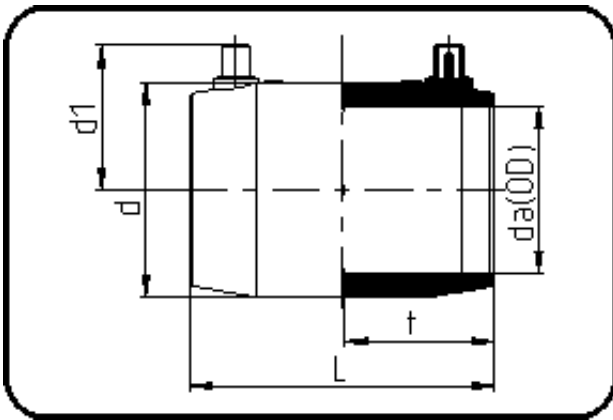

Code: 173

- **E-Muffe**
- MOP Wasser 25bar / Gas 10bar
- MOP Wasser ÖVGW 16bar W/P-TW
- formgespritzt
- **Heizwendelschweissung**
- **PE 100-RC schwarz**

Dimension	Code	Detail	Gewicht
75	70.173.0075.11	75 SDR 17-7,4	0.37

	Einheit	Nominale	Tol+	Tol-
da(OD)	mm	75	0.00	0.00
L	mm	139,5	4.50	0.00
d	mm	97	0.75	0.75
d1	mm	65,5	1.50	1.50
t	mm	68,5	2.25	0.00