

E-Schweissbare Fittings

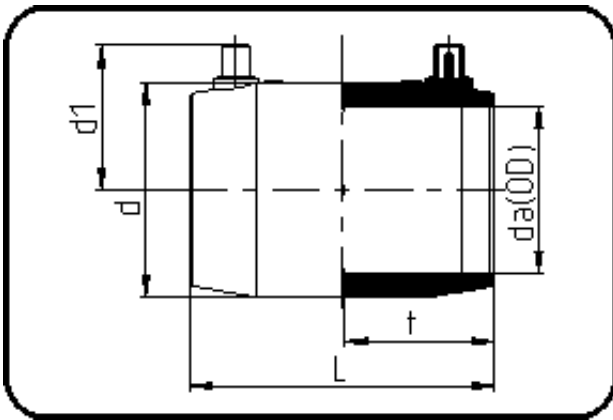

Code: 173

- E-Muffe
- MOP Wasser 10bar / Gas 6bar
- W/P-TW
- formgespritzt
- **Heizwendelschweissung**
- **PE 100-RC schwarz**

Dimension	Code	Detail	Gewicht
450	70.173.0450.17	450 SDR 33-17	16.60

	Einheit	Nominale	Tol+	Tol-
da(OD)	mm	450	0.00	0.00
L	mm	338	6.00	0.00
d	mm	522	1.50	1.50
d1	mm	260	1.50	1.50
t	mm	166,5	4.50	0.00