

E-Schweissbare Fittings

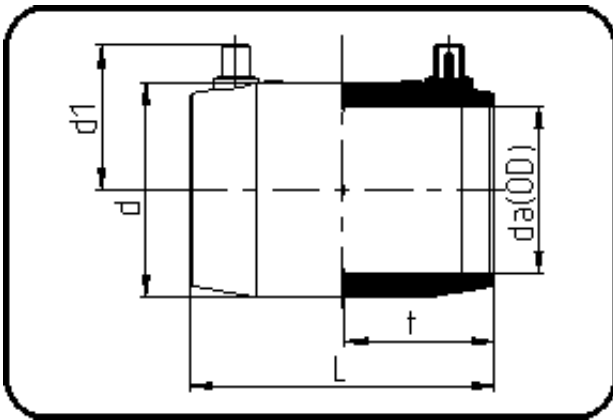

Code: 173

- **E-Muffe**
- MOP Wasser 25bar / Gas 10bar
- MOP Wasser ÖVGW 16bar W/P-TW
- formgespritzt
- **Heizwendelschweissung**
- **PE 100-RC schwarz**

Dimension	Code	Detail	Gewicht
315	70.173.0315.11	315 SDR 26-7,4	8.44

	Einheit	Nominale	Tol+	Tol-
da(OD)	mm	315	0.00	0.00
L	mm	259	6.00	0.00
d	mm	386	1.50	1.50
d1	mm	187	3.00	3.00
t	mm	127,5	4.50	0.00