

E-Schweissbare Fittings

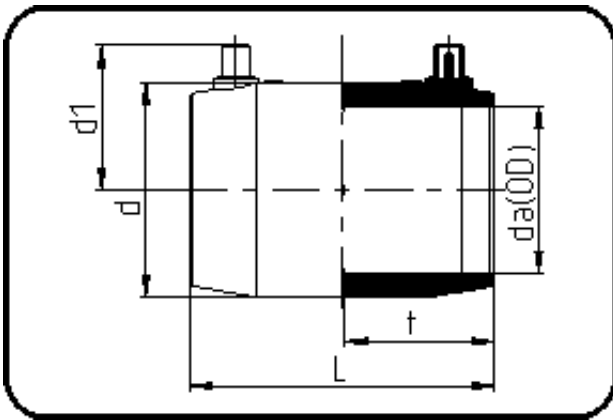

Code: 173

- E-Muffe
- MOP Wasser 10bar / Gas 6bar
- W/P-TW
- formgespritzt
- **Heizwendelschweissung**
- **PE 100-RC schwarz**

| Dimension | Code | Detail | Gewicht |
|-----------|----------------|---------------|---------|
| 315 | 70.173.0315.17 | 315 SDR 33-17 | 6.36 |

| | Einheit | Nominale | Tol+ | Tol- |
|--------|---------|----------|------|------|
| da(OD) | mm | 315 | 0.00 | 0.00 |
| L | mm | 259 | 6.00 | 0.00 |
| d | mm | 366 | 1.50 | 1.50 |
| d1 | mm | 185,5 | 1.50 | 1.50 |
| t | mm | 128 | 4.50 | 0.00 |