

E-Schweissbare Fittings

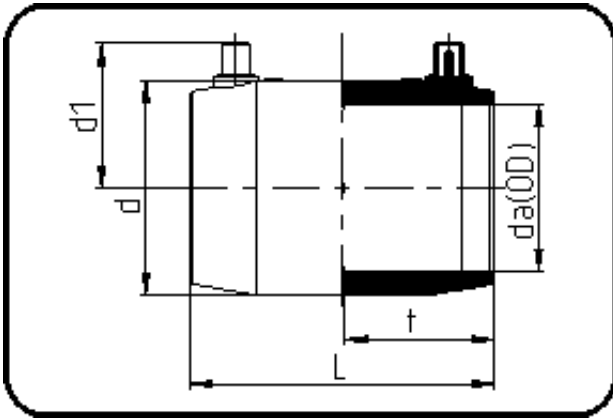

Code: 173

- **E-Muffe**
- MOP Wasser 25bar / Gas 10bar
- MOP Wasser ÖVGW 16bar W/P-TW
- formgespritzt
- **Heizwendelschweissung**
- **PE 100-RC schwarz**

Dimension	Code	Detail	Gewicht
25	70.173.0025.11	25 SDR 11-7,4	0.04

	Einheit	Nominale	Tol+	Tol-
da(OD)	mm	25	0.00	0.00
L	mm	79,5	4.50	0.00
d	mm	35	0.75	0.75
d1	mm	39	1.50	1.50
t	mm	39,5	1.50	0.00