

E-Schweissbare Fittings

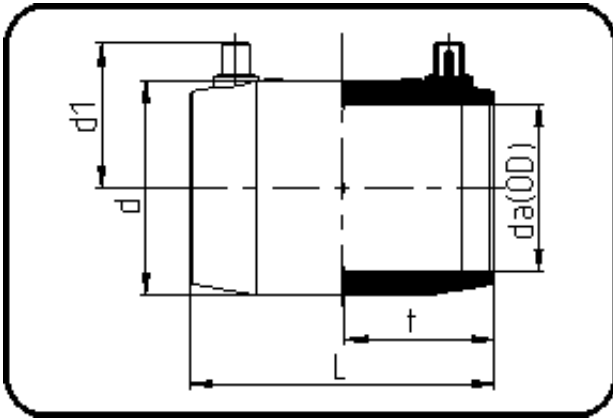

Code: 173

- E-Muffe
- MOP Wasser 10bar / Gas 6bar
- W/P-TW
- formgespritzt
- **Heizwendelschweissung**
- **PE 100-RC schwarz**

Dimension	Code	Detail	Gewicht
250	70.173.0250.17	250 SDR 26-17	4.01

	Einheit	Nominale	Tol+	Tol-
da(OD)	mm	250	0.00	0.00
L	mm	240	6.00	0.00
d	mm	293	1.50	1.50
d1	mm	152,5	1.50	1.50
t	mm	118	4.50	0.00