

E-Schweissbare Fittings

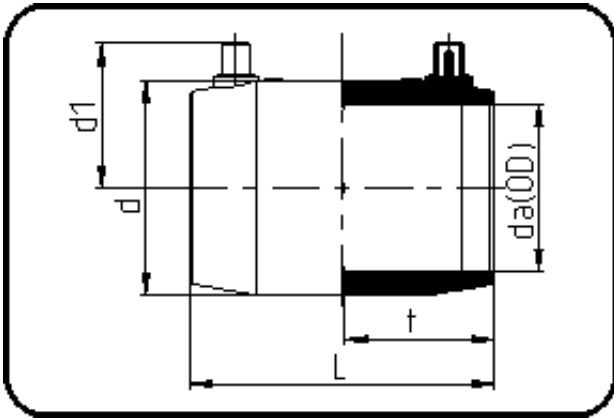

Code: 173

- **E-Muffe**
- MOP Wasser 25bar / Gas 10bar
- MOP Wasser ÖVGW 16bar W/P-TW
- formgespritzt
- **Heizwendelschweissung**
- **PE 100-RC schwarz**

Dimension	Code	Detail	Gewicht
180	70.173.0180.11	180 SDR 26-7,4	2.49

	Einheit	Nominale	Tol+	Tol-
da(OD)	mm	180	0.00	0.00
L	mm	199,5	4.50	0.00
d	mm	221	1.50	1.50
d1	mm	119	1.50	1.50
t	mm	97,5	4.50	0.00