

E-Schweissbare Fittings

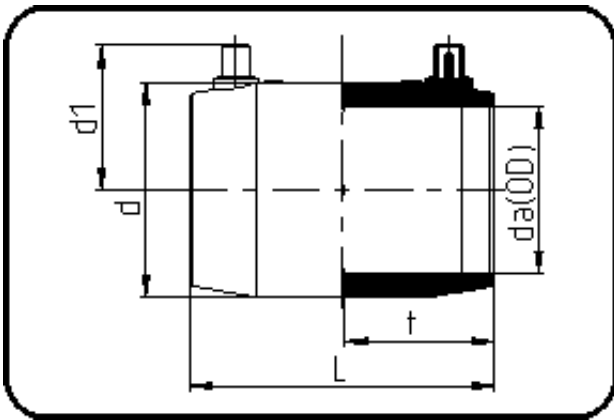

Code: 173

- **E-Muffe**
- MOP Wasser 25bar / Gas 10bar
- MOP Wasser ÖVGW 16bar W/P-TW
- formgespritzt
- **Heizwendelschweissung**
- **PE 100-RC schwarz**

Dimension	Code	Detail	Gewicht
140	70.173.0140.11	140 SDR 17-7,4	1.36

	Einheit	Nominale	Tol+	Tol-
da(OD)	mm	140	0.00	0.00
L	mm	179	4.50	0.00
d	mm	180	1.50	1.50
d1	mm	99	1.50	1.50
t	mm	88,5	3.00	0.00