

## E-Schweissbare Fittings

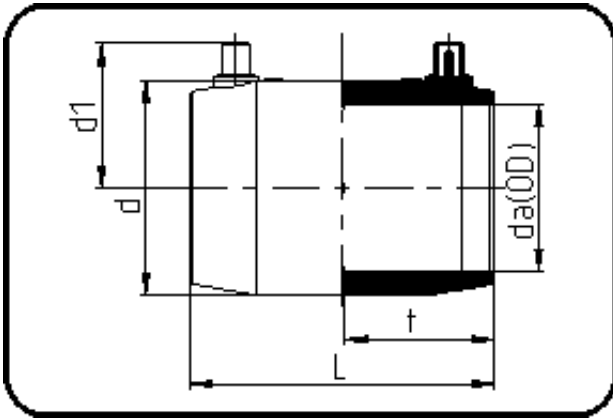

Code: 173

- **E-Muffe**
- MOP Wasser 25bar / Gas 10bar
- MOP Wasser ÖVGW 16bar W/P-TW
- formgespritzt
- **Heizwendelschweissung**
- **PE 100-RC schwarz**

Dimension	Code	Detail	Gewicht
125	70.173.0125.11	125 SDR 17-7,4	0.99

	Einheit	Nominale	Tol+	Tol-
da(OD)	mm	125	0.00	0.00
L	mm	169,5	4.50	0.00
d	mm	155	1.50	1.50
d1	mm	91	1.50	1.50
t	mm	83,5	3.00	0.00