

## E-Schweissbare Fittings

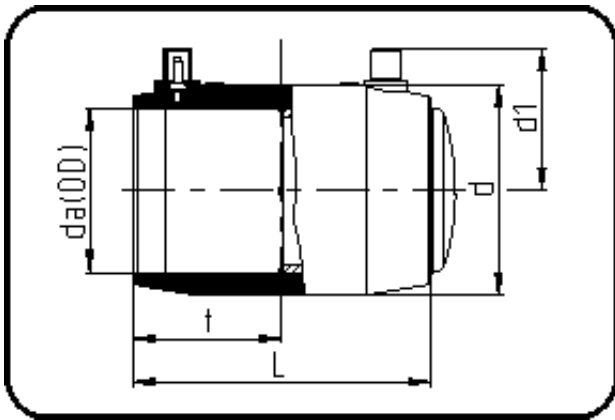

Code: 174

- E-Endkappe
- MOP Wasser 16bar / Gas 10bar
- W/P-TW
- formgespritzt
- Heizwendelschweissung
- PE 100-RC schwarz

Dimension	Code	Detail	Gewicht
160	70.174.0160.11	160 SDR 17-11	2.92

	Einheit	Nominale	Tol+	Tol-
da(OD)	mm	160	0.00	0.00
L	mm	180	4.50	0.00
d	mm	197	1.50	1.50
d1	mm	107,5	0.75	0.75
t	mm	88	4.50	0.00