

## E-Schweissbare Fittings

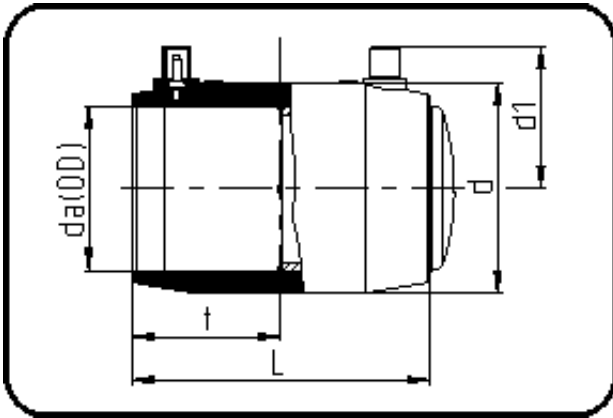

Code: 174

- E-Endkappe
- MOP Wasser 16bar / Gas 10bar
- W/P-TW
- formgespritzt
- Heizwendelschweissung
- PE 100-RC schwarz

| Dimension | Code           | Detail        | Gewicht |
|-----------|----------------|---------------|---------|
| 125       | 70.174.0125.11 | 125 SDR 17-11 | 1.61    |

|        | Einheit | Nominale | Tol+ | Tol- |
|--------|---------|----------|------|------|
| da(OD) | mm      | 125      | 0.00 | 0.00 |
| L      | mm      | 169,5    | 4.50 | 0.00 |
| d      | mm      | 155      | 1.50 | 1.50 |
| d1     | mm      | 91       | 1.50 | 1.50 |
| t      | mm      | 83,5     | 3.00 | 0.00 |