

E-Schweissbare Fittings

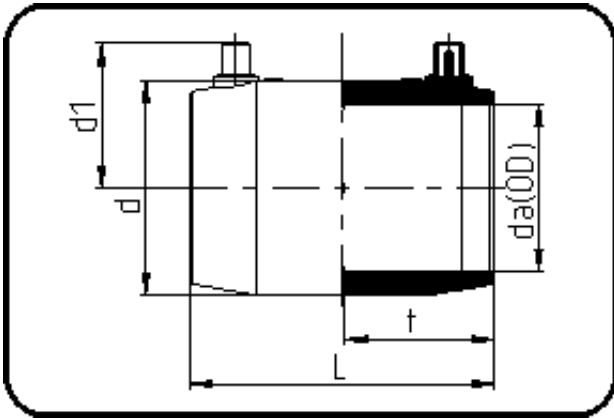

Code: 173

- E-Muffe
- MOP Wasser 10bar / Gas 6bar
- W/P-TW
- formgespritzt
- **Heizwendelschweissung**
- **PE 100-RC schwarz**

Dimension	Code	Detail	Gewicht
355	70.173.0355.17	355 SDR 33-17	8.73

	Einheit	Nominale	Tol+	Tol-
da(OD)	mm	355	0.00	0.00
L	mm	281	6.00	0.00
d	mm	413	1.50	1.50
d1	mm	205,5	1.50	1.50
t	mm	138,5	4.50	0.00